

**GIANFORCARO
ARCHITECTS
ENGINEERS
& PLANNERS**

555 EAST MAIN ST.
CHESTER, N.J. 07930
PHONE: (908) 879-6001
FAX: (908) 879-8505

- ARCHITECTURAL
- CIVIL
- STRUCTURAL
- CONSTRUCTION
- ENVIRONMENTAL
- MECHANICAL
- FORENSIC

ANTHONY GIANFORCARO, AIA, PE
REGISTERED ARCHITECT
N.J. LIC. NO. 13996
PROFESSIONAL ENGINEER
N.J. LIC. NO. 39006
PA. LIC. NO. 43077

GEORGE F. GIANFORCARO, PE, PFP
PROFESSIONAL ENGINEER
N.J. LIC. NO. 18288
PA. LIC. NO. 17377
N.Y. LIC. NO. 52202
PROFESSIONAL PLANNER
N.J. LIC. NO. 3501

**SYNTHETIC TURF
FIELD AND FIELD
LIGHTING**

**AT THE
MT. OLIVE
HIGH SCHOOL**

**FOR THE
MT. OLIVE
BOARD OF
EDUCATION**

**MORRIS COUNTY
NEW JERSEY**

DEMOLITION PLAN

SCALE: AS NOTED

DATE	DRAWN
8/12/21	MGG
	CHECKED
	AG

FILE: MOHSBaseballTurfR8

REVISION

SP-1

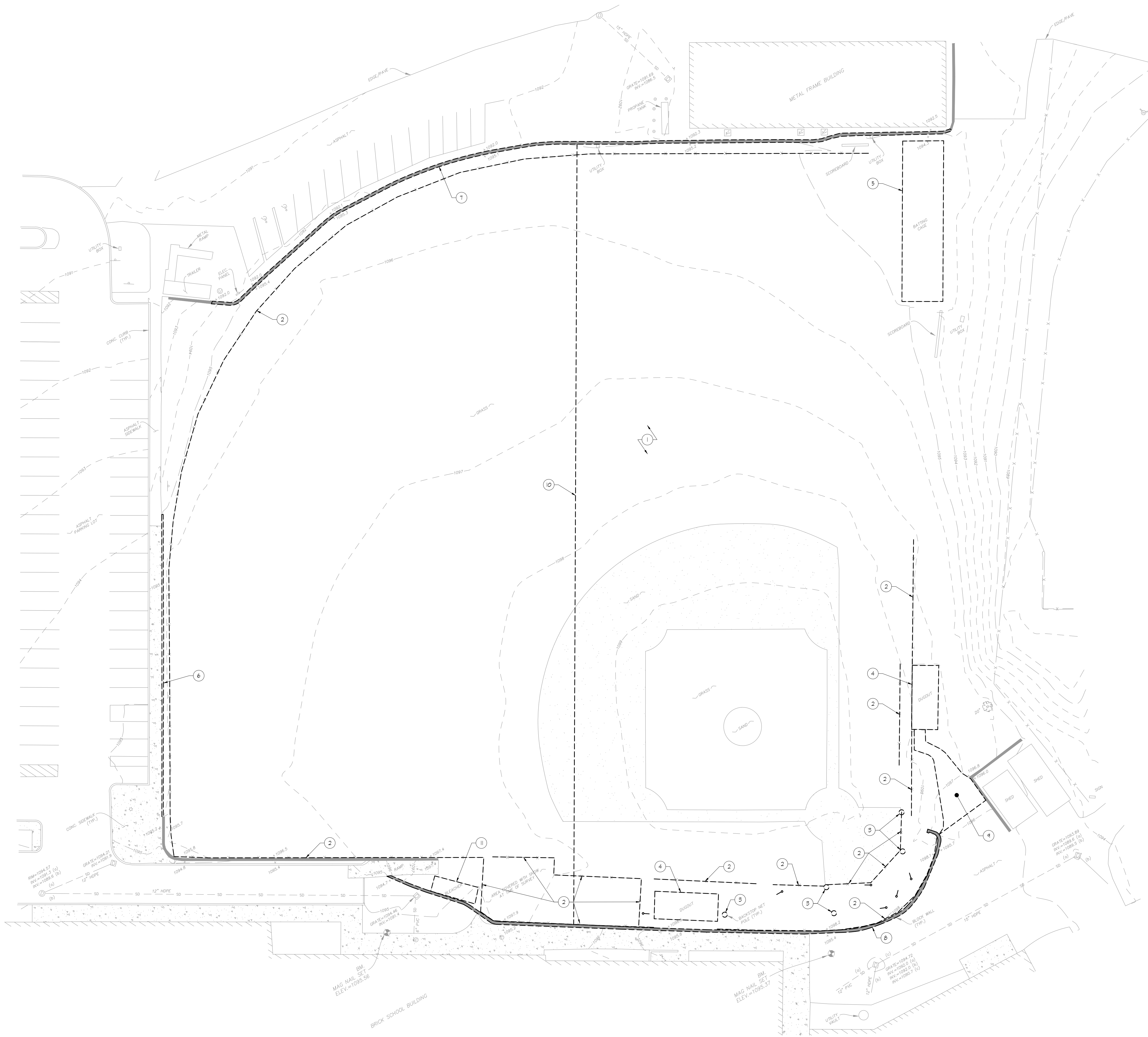

- DEMOLITION NOTES:**
- EXCAVATE A MINIMUM OF 12" OVER ENTIRE FIELD IN PREPARATION OF NEW UNDERGROUND UTILITIES, STONE AND SYNTHETIC TURF. REMOVE CLAY INFILL, BASEBALL BASES, AND PITCHERS MOUND.
 - REMOVE CHAINLINK FENCES IN THEIR ENTIRETY, INCLUDING POLES, FOOTINGS, CROSS RAILS, AND FABRIC. REMOVE BASEBALL BACKSTOP IN ITS ENTIRETY.
 - REMOVE NET POLES, SUPPORTS AND ALL NETTING.
 - REMOVE DUGOUT IN ITS ENTIRETY. REMOVE ALL CONCRETE BLOCK, SLAB AND FOUNDATION. COORDINATE WITH NEW DUGOUT LOCATION, BACKFILL AND COMPACT AREA AS NECESSARY.
 - REMOVE BATING GAZE IN ITS ENTIRETY, INCLUDING ALL MULCH AND TIMBERS. RETURN ALL GAZE MATERIALS TO OWNER.
 - REMOVE EXISTING CONCRETE SIDEWALK CURB IN PREPARATION FOR NEW RETAINING WALL.
 - REMOVE EXISTING RETAINING WALL, CAP STONE, AND ALL NECESSARY BLOCKS IN ORDER TO MAKE TOP OF EXISTING WALL FLUSH WITH NEW SYNTHETIC TURF CONCRETE CURB. STEP EXISTING RETAINING WALL AS NECESSARY. REPLACE ALL EXISTING CAP STONE. REPLACE ALL BROKEN CAP STONES WITH NEW TO MATCH EXISTING.
 - REMOVE EXISTING RETAINING WALL, CAP STONE IN PREPARATION FOR INSTALLATION OF ADDITIONAL BLOCK COURSES. ALL CAP STONE SHALL BE REPLACED AT NEW TOP OF WALL. ALL BROKEN CAP STONES SHALL BE REPLACED WITH NEW TO MATCH EXISTING.
 - SAW CUT AND REMOVE EXISTING ASPHALT PATH WHERE SHOWN.
 - THERE IS AN EXISTING 4" UNDERGROUND CONDUIT APPROXIMATELY WHERE SHOWN. THE CONDUIT AND ALL WIRING SHALL BE LOWERED A MINIMUM OF 2'-0". THIS WORK MUST BE DONE BY THE SPECIFIED ELECTRICAL SUBCONTRACTOR.
 - REMOVE EXISTING PORTABLE BLEACHERS AND RETURN TO OWNER.

**ALL SURVEY DATA
TAKEN FROM:**

V5 LAND DATA
V5 HEADQUARTERS
80 River Rd, 1st Fl, 106
Phillipsburg, NJ 08865
P: 609.676.4425
F: 609.220.6234
www.v5landdata.com
NJ Certificate of Authorization
#PA02013500
John J. Hanlon
Professional Land Surveyor
New Jersey License No. 37504
Pennsylvania License No. SU660784

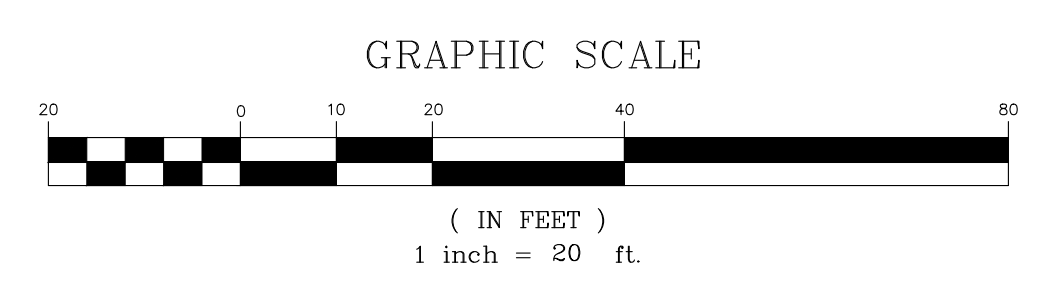

1 DEMOLITION PLAN
1" = 20'-0"