

**GIANFORCARO
ARCHITECTS
ENGINEERS
& PLANNERS**

555 EAST MAIN ST.
CHESTER, N.J. 07930
PHONE: (908) 879-6001
FAX: (908) 879-8505

- ARCHITECTURAL
- CIVIL
- STRUCTURAL
- CONSTRUCTION
- ENVIRONMENTAL
- MECHANICAL
- FORENSIC

ANTHONY GIANFORCARO, AIA, PE
REGISTERED ARCHITECT
N.J. LIC. NO. 13996
PROFESSIONAL ENGINEER
N.J. LIC. NO. 39006
PA. LIC. NO. 43077

GEORGE F. GIANFORCARO, PE, PP
PROFESSIONAL ENGINEER
N.J. LIC. NO. 15298
PA. LIC. NO. 17377
N.Y. LIC. NO. 52202
PROFESSIONAL PLANNER
N.J. LIC. NO. 3501

**SYNTHETIC TURF
FIELD AND FIELD
LIGHTING**

**AT THE
MT. OLIVE
HIGH SCHOOL**

**FOR THE
MT. OLIVE
BOARD OF
EDUCATION**

**MORRIS COUNTY
NEW JERSEY**

**ELECTRICAL SITE
PLAN**

SCALE: AS NOTED

DATE	DRAWN
8/12/21	MGG
	CHECKED
	AG

FILE: MOHSBaseballTurfR8

REVISION

SP-2.3

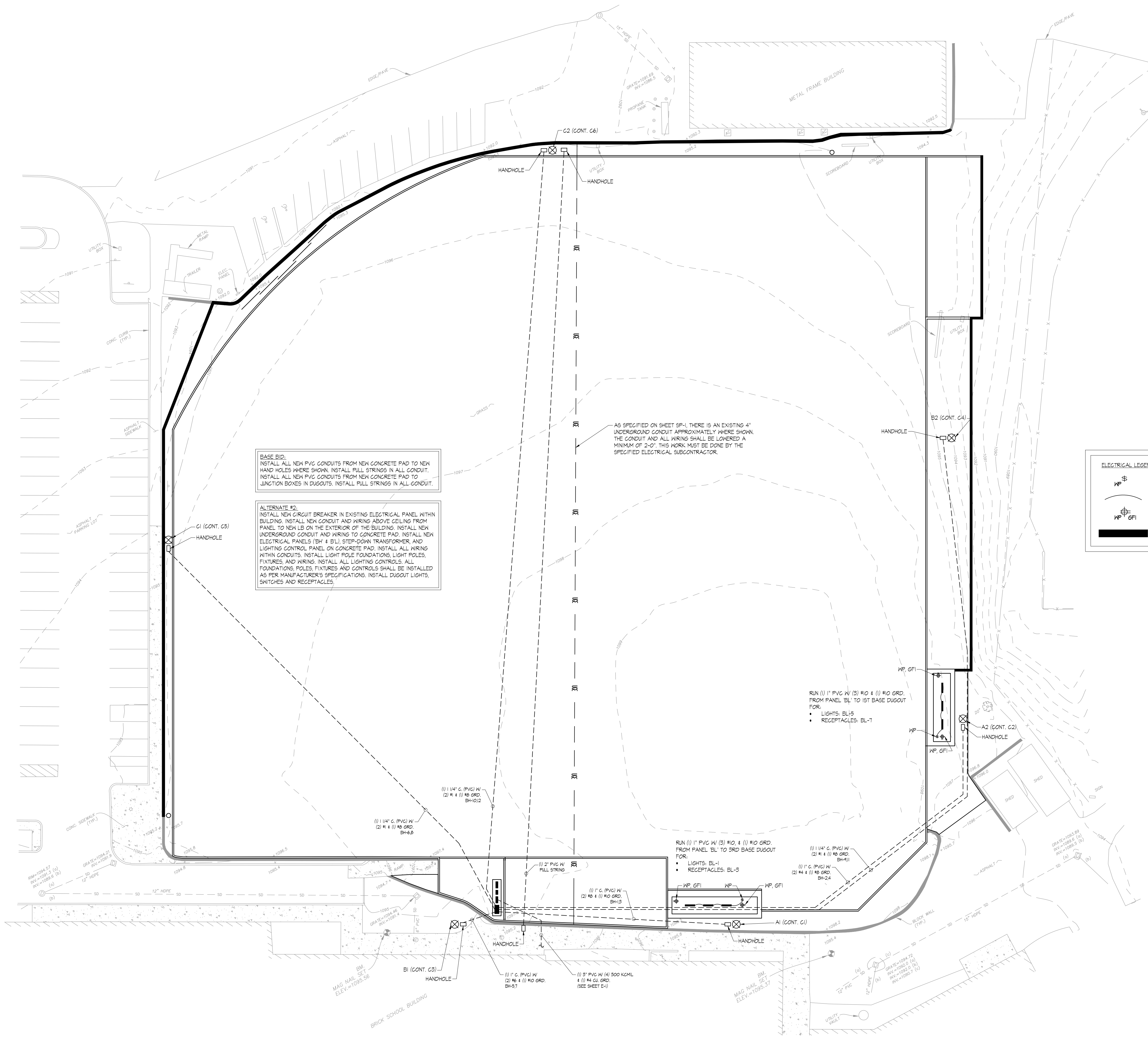

BASE BID:
INSTALL ALL NEW PVC CONDUITS FROM NEW CONCRETE PAD TO NEW HAND HOLES WHERE SHOWN. INSTALL PULL STRINGS IN ALL CONDUIT. INSTALL ALL NEW PVC CONDUITS FROM NEW CONCRETE PAD TO JUNCTION BOXES IN DUGGOTS. INSTALL PULL STRINGS IN ALL CONDUIT.

ALTERNATE #2:
INSTALL NEW CIRCUIT BREAKER IN EXISTING ELECTRICAL PANEL WITHIN BUILDING. INSTALL NEW CONDUIT AND WIRING ABOVE CEILING FROM PANEL TO NEW LB ON THE EXTERIOR OF THE BUILDING. INSTALL NEW UNDERGROUND CONDUIT AND WIRING TO CONCRETE PAD. INSTALL NEW ELECTRICAL PANELS (B# 1 & 2), STEP-DOWN TRANSFORMER, AND LIGHTING CONTROL PANEL ON CONCRETE PAD. INSTALL ALL WIRING WITHIN CONDUITS. INSTALL LIGHT POLE FOUNDATIONS, LIGHT POLES, FIXTURES, AND WIRING. INSTALL ALL LIGHTING CONTROLS. ALL FOUNDATIONS, POLES, FIXTURES AND CONTROLS SHALL BE INSTALLED AS PER MANUFACTURER'S SPECIFICATIONS. INSTALL DUGGOT LIGHTS, SWITCHES AND RECEPTACLES.

ELECTRICAL LEGEND (ALTERNATE #1)

	WEATHER PROTECTED SINGLE POLE TOGGLE SWITCH- G.L. 48" A.F.F.
	CONDUIT RUN EXPOSED
	GROUND FAULT CIRCUIT INTERRUPTER 10V, DUPLEX OUTLET 18" A.F.F.
	HOLOGRAM EV74 LED 8000LM P.R.L. 120V 6210 50K 80 CRI KLF GMB

RUN (1) 1" PVC W/ (3) #10 & (1) #10 GRD. FROM PANEL B1 TO 1ST BASE DUGGOT FOR:
 • LIGHTS: BL-5
 • RECEPTACLES: BL-7

RUN (1) 1" PVC W/ (3) #10 & (1) #10 GRD. FROM PANEL B1 TO 3RD BASE DUGGOT FOR:
 • LIGHTS: BL-1
 • RECEPTACLES: BL-3

**ALL SURVEY DATA
TAKEN FROM:**
 V5 LAND DATA
 V5 HEADQUARTERS
 20 River Rd. 1st Fl.
 Phillipsburg, NJ 08865
 P: 609.676.4425
 F: 609.220.6234
 www.v5landdata.com
 NJ Certificate of Authorization
 #PAC0213500
 John J. Hanlon
 Professional Land Surveyor
 New Jersey License No. 37504
 Pennsylvania License No. SU660784

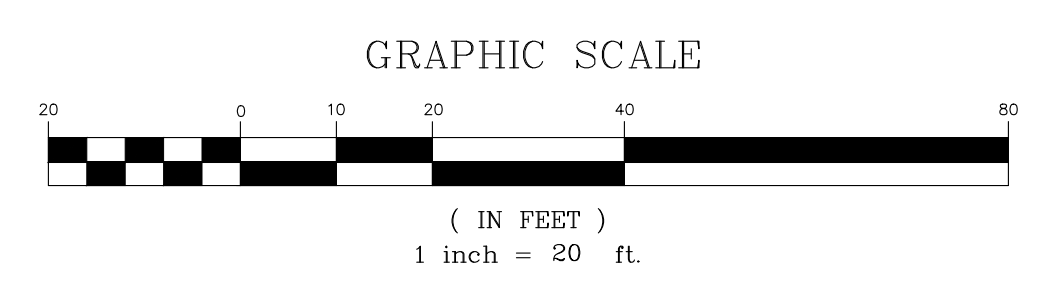

1 ELECTRICAL SITE PLAN
1" = 20'-0"