

**GIANFORCARO
ARCHITECTS
ENGINEERS
& PLANNERS**

555 EAST MAIN ST.
CHESTER, N.J. 07930
PHONE: (908) 879-6001
FAX: (908) 879-8505

- ARCHITECTURAL
- CIVIL
- STRUCTURAL
- CONSTRUCTION
- ENVIRONMENTAL
- MECHANICAL
- FORENSIC

ANTHONY GIANFORCARO, AIA, PE
REGISTERED ARCHITECT
N.J. LIC. NO. 13996
PROFESSIONAL ENGINEER
N.J. LIC. NO. 39006
PA. LIC. NO. 43077

GEORGE F. GIANFORCARO, PE, PFP
PROFESSIONAL ENGINEER
N.J. LIC. NO. 15288
PA. LIC. NO. 17377
N.Y. LIC. NO. 52202
PROFESSIONAL PLANNER
N.J. LIC. NO. 3501

**SYNTHETIC TURF
FIELD AND FIELD
LIGHTING**

**AT THE
MT. OLIVE
HIGH SCHOOL**

**FOR THE
MT. OLIVE
BOARD OF
EDUCATION**

**MORRIS COUNTY
NEW JERSEY**

FENCING PLAN

SCALE: AS NOTED

DATE	DRAWN
8/12/21	MGG
	CHECKED
	AG

FILE: MOHSBaseballTurfR8

REVISION

SP-2.4

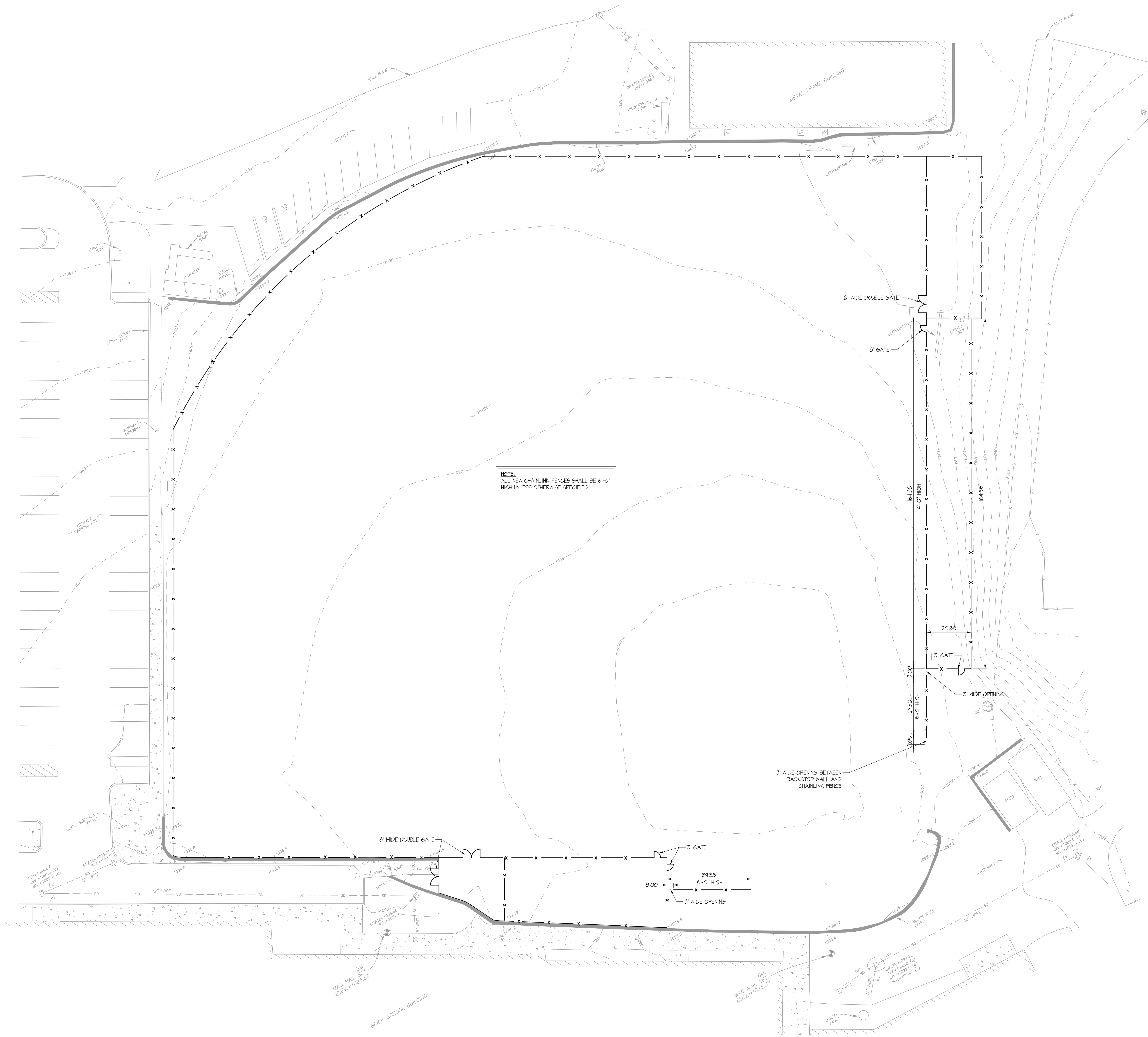

NOTE:
ALL NEW CHAINLINK FENCES SHALL BE 6'-0"
HIGH UNLESS OTHERWISE SPECIFIED.

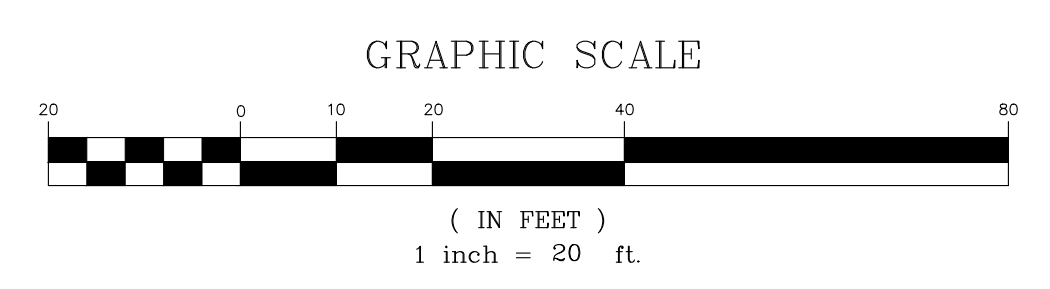

1 CONSTRUCTION PLAN
1" = 20'-0"

ALL SURVEY DATA
TAKEN FROM:
V5 LAND DATA
V5 HEADQUARTERS
20 River Rd, 1st Fl
Phillipsburg, NJ 08865
P: 609.676.4425
F: 609.220.6234
www.v5landdata.com
NJ Certificate of Authorization
FPA02015000
John J. Hanlon
Professional Land Surveyor
New Jersey License No. 37504
Pennsylvania License No. SU66784